

SECTION II

TM 9-2320-365-24P

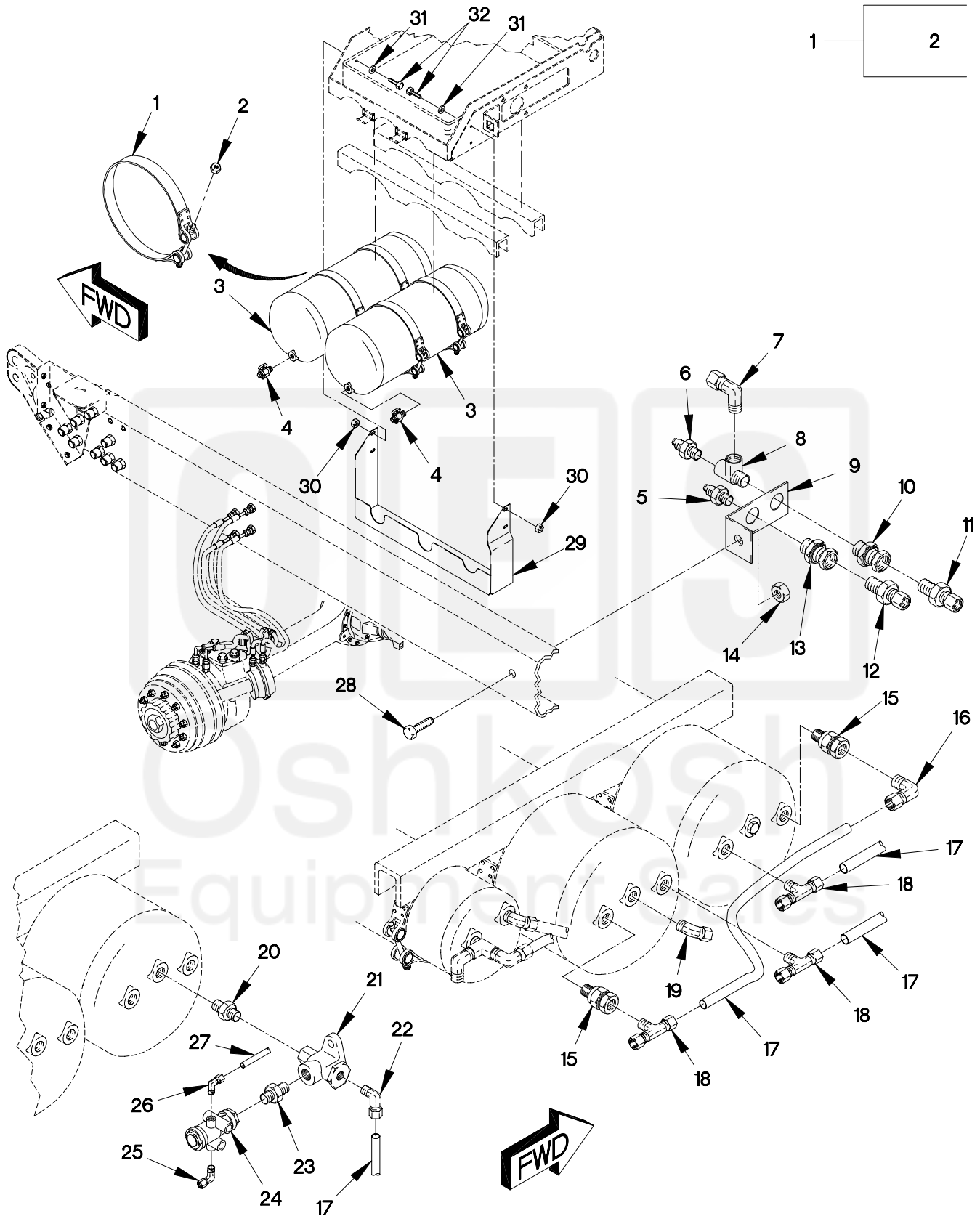

FIGURE 141. AIR TANKS, CLAMPS, HOSES AND FITTINGS

1208AD1C

SECTION II

TM 9-2320-365-24P

(1) ITEM NO	(2) SMR CODE	(3) CAGEC	(4) PART NUMBER	(5) DESCRIPTION AND USABLE ON CODE (UOC)	(6) QTY
GROUP 1208: AIR BRAKE SYSTEM FIG.141 AIR TANKS,CLAMPS,HOSES AND FITTINGS					
1	PAOZZ	19207	12421379-002	CLAMP,LOOP.....	4
2	PAOZZ	96906	MS21045L5	.NUT,SELF-LOCKING,H 5/16-24.....	1
3	PAOZZ	0FW39	12414369-001	TANK,PRESSURE.....	2
4	PAOZZ	06721	N-30256-C	COCK,SHUTOFF,SCREW.....	2
5	PAOZZ	96906	MS35869-22	ADAPTER,STRAIGHT,PI.....	2
6	PAOZZ	81343	4-6-010102B	ADAPTER,STRAIGHT,PI.....	1
7	PAOZZ	81343	6-6 100202BA	ELBOW,PIPE TO TUBE.....	1
8	PAOZZ	81343	6-6-6 130424B	TEE,PIPE.....	1
9	PAOZZ	19207	12418278	BRACKET,ANGLE.....	1
10	PAOZZ	93061	207ACBH-6	COUPLING,PIPE.....	1
11	PAOZZ	79470	1468X6X6	ADAPTER,STRAIGHT,PI.....	1
12	PAOZZ	81343	4-4-100102BA	ADAPTER,STRAIGHT,P.....	1
13	PAOZZ	93061	207ACBHS-4	COUPLING,PIPE.....	1
14	PAOZZ	19207	12414308-022	NUT,SELF-LOCKING,EX.....	1
15	PAOZZ	06721	N13526H	VALVE,CHECK.....	2
16	PAOZZ	81343	8-8 100202BA	ELBOW,PIPE TO TUBE.....	2
17	PAOZZ	0FW39	12420572-008X	HOSE,NONMETALLIC.....	4
18	PAOZZ	93061	272NTA-8-8	TEE,PIPE TO TUBE.....	1
19	PAOZZ	81343	8-8 100302BA	ELBOW,PIPE TO TUBE.....	1
20	PAOZZ	81343	8-6 140137C	REDUCER,PIPE.....	1
21	PAOZZ	0FW39	12378837-001	VALVE,CHECK.....	1
22	PAOZZ	81343	8-6 100202BA	ELBOW,PIPE TO TUBE.....	1
23	PAOZZ	81343	6-4 140137C	REDUCER,PIPE.....	1
24	PAFZZ	06853	101450	VALVE,PLUG.....	1
25	PAOZZ	79470	1469X4X4	ELBOW,PIPE TO TUBE.....	1
26	PAOZZ	81343	6-2 100202BA	ELBOW,PIPE TO TUBE.....	1
27	MOOZZ	0FW39	12420572-006X	TUBE,NONMETALLIC MAKE FROM HOSE P/N: J844TYBSIZE 3/8 BLACK (81343), CUT TO LENGTH.....	V
28	PAOZZ	19207	12414419-136	SCREW,CAP,HEXAGON H.....	1
29	PAOZZ	0FW39	TV990021	SHIELD,VALVE,AIR.....	1
30	PAOZZ	0FW39	12414474-040	NUT,PLAIN,HEXAGON M10 X 1.5.....	10
31	PAOZZ	0FW39	12414473-056	WASHER,FLAT M10.....	10
32	PAOZZ	19207	12414419-324	SCREW.....	4

END OF FIGURE